



# CRY3719

## IEC 60318-5 Hearing Aids and In-ear Headphones Measurement 2cc Coupler

### Features

- **Key Specifications**

Frequency Range	125 Hz to 8 kHz
Equivalent Volume	2cc

- **Applications**

Hearing aids measurements  
In-ear headphones measurements

- **Standards**

IEC 60318-5 Electroacoustics – Simulators of human head and ear – Part 5  
ANSI S3.7  
IEC 61094-4

### Introduction

CRY3719 is a 2cc coupler designed specifically for audiometry and acoustic testing of insert earphones.

The unique design of CRY3719 features a resonant frequency of 22.4kHz, effectively avoiding interference with measurements within the audible frequency range. This enables stable and reliable high-quality acoustic testing.

### Highlights

- **Use of Coupler Compliant with IEC 60318-5**

Describes an acoustic coupler for loading an earphone or hearing aid with a specified acoustic impedance when determining its physical performance characteristics, in the frequency range 125 Hz to 8 kHz.

It is suitable for air conduction hearing aids and earphones, coupled to the ear by means of ear inserts e.g. ear moulds or similar devices.

- **Compatibility**

CRY3719 coupler can be compatible with 1/2" pressure field measurement microphones, such as CRY3202, CRY3204 and other measurement microphones.

- **Calibration**

Each CRY SOUND coupler is calibrated at the factory using traceable calibration equipment.

Calibration certificates are provided with each unit. CRY SOUND recommends recalibration at least once a year.

- **Quality & Warranty**

All CRY SOUND couplers are primarily made of stainless steel, which offers high corrosion resistance, durability, and the ability to withstand high pressure and temperature.

CRY SOUND couplers are supported by a 10-year warranty—offering one of the best service guarantee in the world.

## Technical Specifications

### Specifications

Resonance Frequency	22.4kHz $\pm$ 2.5kHz
Frequency Range	125 Hz to 8 kHz
Equivalent Volume	2 cc (2 cm <sup>3</sup> )
Weight	50g

### Frequency Response

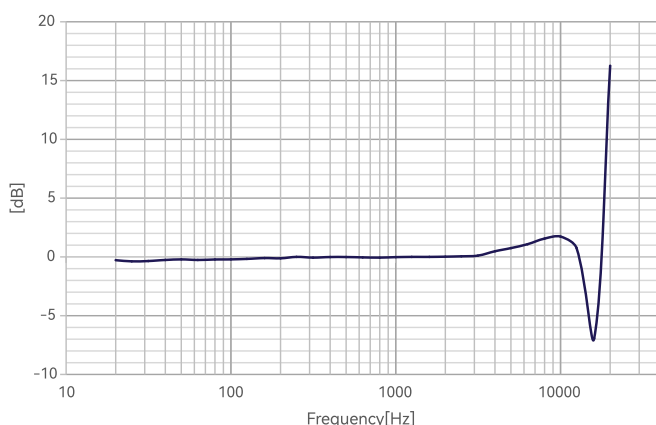

Fig.1 CRY3719 Coupler+CRY3202 Microphone+CRY3502 Preamplifier Frequency Response

### Dimensions

Height	28 mm (1.1")
Diameter	25 mm (0.985")

### Drawings(mm)[inch]

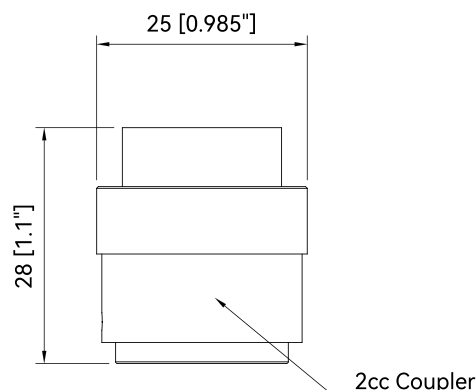

Fig.2 CRY3719 Coupler Drawings

### Diagram



Fig.3 CRY3719 Coupler Optional Acoustic Chamber Configuration Diagram

Here are the three optional acoustic chamber configuration diagrams for the CRY3719 Coupler. You can freely choose and combine the most suitable chamber configuration based on your specific testing needs. Please note that the provided diagrams are for reference purposes only and can be further customized according to your specific requirements and objectives.

## Ordering Information

### Optional Accessories

Measurement Microphone	CRY3202 1/2" Pressure-field Prepolarized Microphone
Preamplifier	CRY3502 1/2" IEPE Preamplifier
Electroacoustic Analyzer	CRY6151B Electroacoustic Analyzer
Power Supply	CRY575 Three-channel Microphone Power Supply
Cable	SMB to BNC Cable /1.5m

### Related Products

CRY3711	IEC 60318-4 Insert earphones Measurement Occluded-ear simulator
CRY3717	IEC 60318-3 Supra-aural Audiometry Earphone Calibration 6cc Coupler
CRY3718	IEC 60318-1 Supra-aural and Circum-aural Earphone Measurement Ear Simulator
CRY3721	IEC 60318-4, Ultra Low-noise, Full- frequency Ear Simulator