

CRY512 Pre-amplifier

CRY512 IEPE Pre-amplifier is a pre-amplifier powered by a constant current source. This pre-amplifier has the characteristic of high input impedance, low noise, and wide frequency response. It can be used with the CRY300 series 1/2-inch pre-polarized measurement microphone, and it's also compatible with other brands of measurement microphones such as B&K, G.R.A.S.

CRY512 pre-amplifier uses a SMB interface. With the SMB(M) to BNC(M) cable, CRY512 can connect to various kind of electroacoustic testers. The stainless steel material makes it sturdy and durable, also give it a long-term stability.

CRY512 Pre-amplifier is suitable for electroacoustic testers, multi-channel analyzers and other instruments.

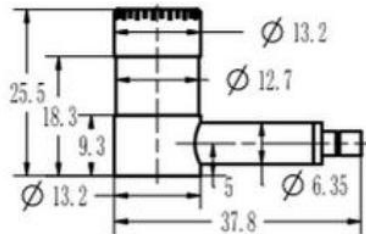

Dimension of CRY512+CRY331

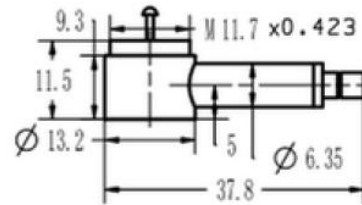

Dimension of CRY512

SPECIFICATIONS

| CRY512 Pre-amplifier | |
|-----------------------------|---|
| Frequency Response | 20Hz ~ 50kHz (± 0.2 dB) 10Hz ~ 100kHz (± 0.5 dB) |
| Input Impedance | >2 G Ω / 50 pF |
| Output Impedance | <20 Ω |
| Distortion (THD) | $<0.1\%$ |
| Max Output Voltage | >5.0 V _{rms} (+24V Power Supply) |
| Power Supply | IEPE (2 mA ~ 10mA) |
| Typical Working Current | 4mA |
| Noise (A-weighting) | <3 μ V _{rms} |
| Noise, Linearity (20-20kHz) | <10 μ V _{rms} |
| Gain | -0.3dB |
| Interface | SMB |
| Working Temperature | -30°C to +70°C |
| Thread Fitting Port | 11.7mm x 60UNS (M11.7 x 0.423mm) |